

246-000027

Minifix Screw

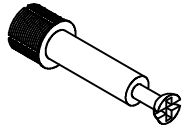

X8

A

Minifix

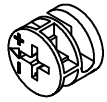

X8

B

Wood Minifix

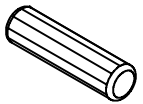

X2

C

Wire box

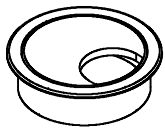

X1

D

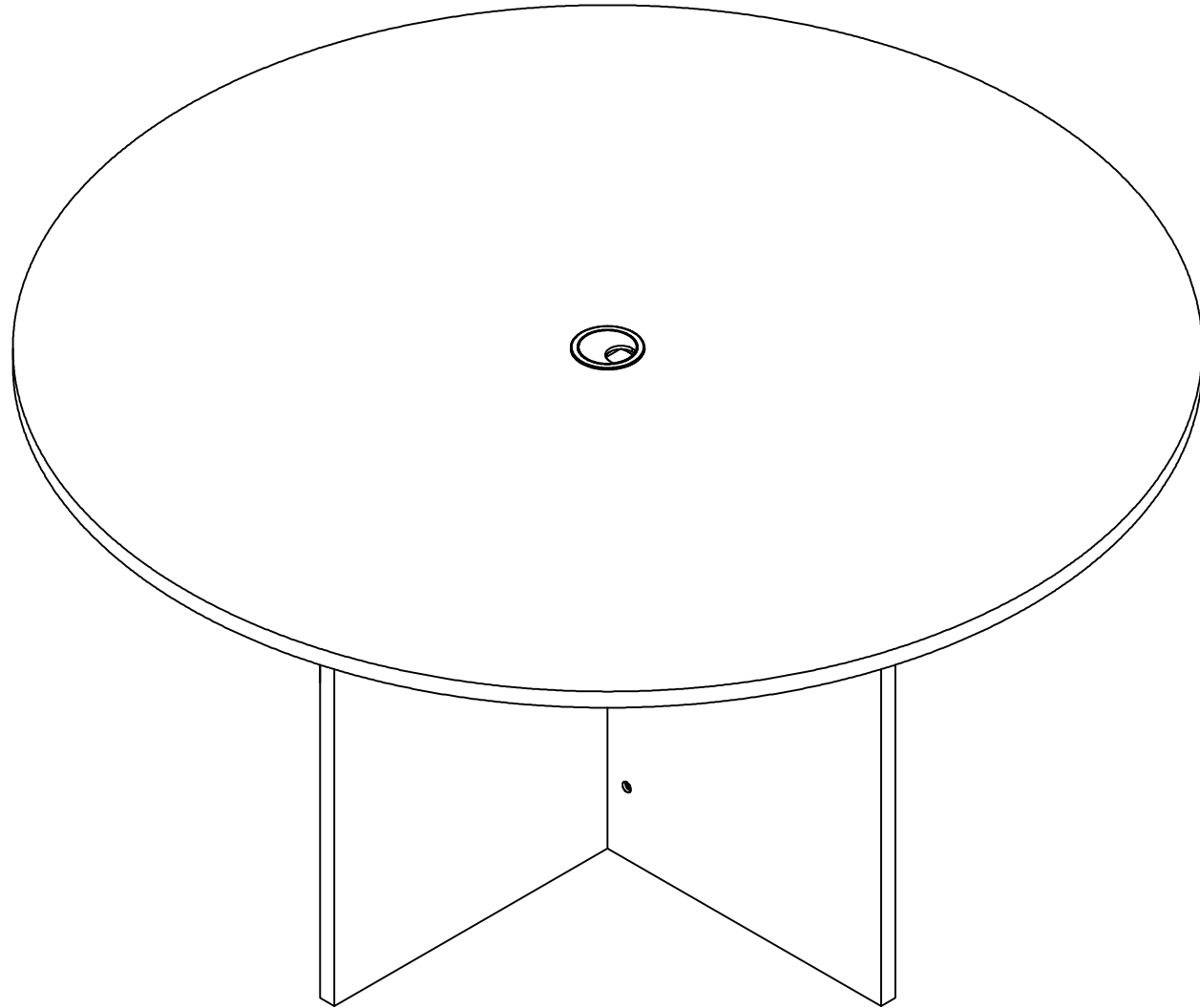

(\varnothing 1500X760)

STEP:1

To fix the table leg panels (1,2,3)

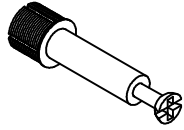

X4

A

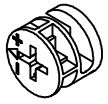

X4

B

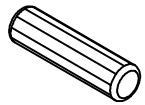

X2

C

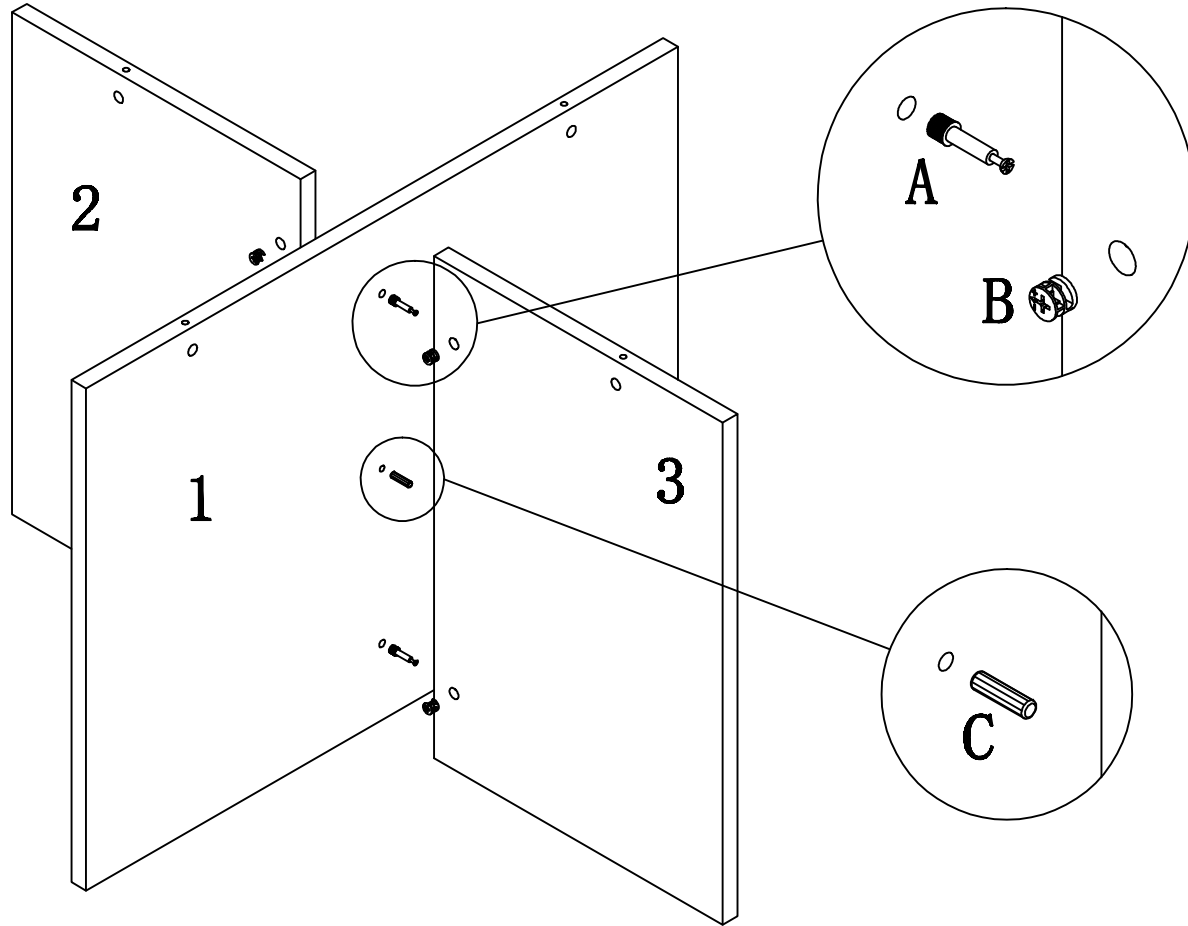

STEP:2

To fix the minifix screw A on table top panel (4)

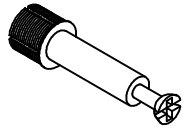

X4

A

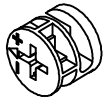

X4

B

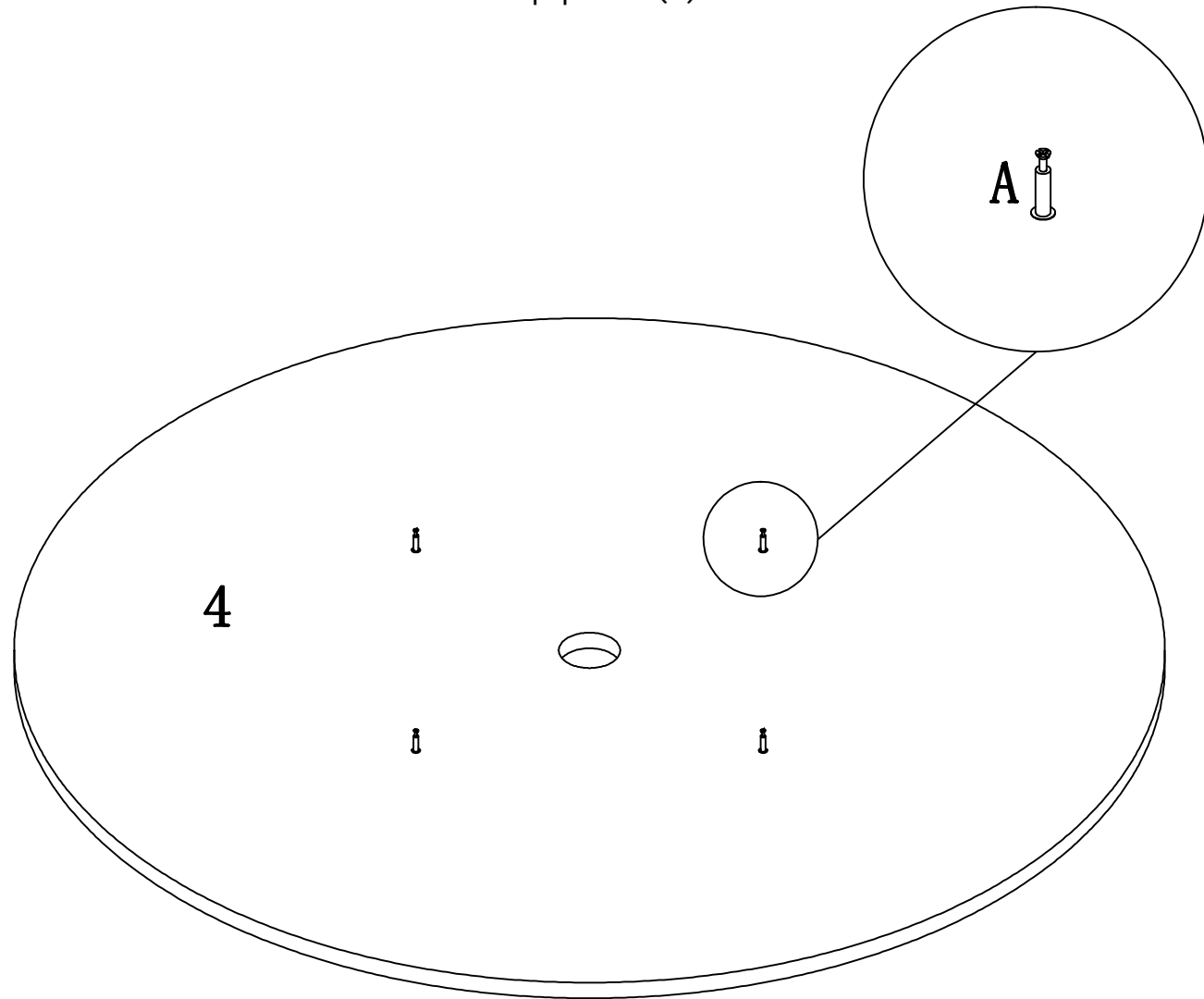

STEP:3

FINISH

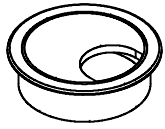

X1

D

To fix table top panel (4)

